



ERIN COATES

KINESPHERE

13 SEPTEMBER – 2 NOVEMBER 2014

CENTRAL GALLERIES

CATALYST: KATHERINE HANNAY

VISUAL ARTS COMMISSION

Inspired by Erin Coates' background in urban climbing and her interest in architecture and body politics, **KINESPHERE** is the artist's largest project to date and has been specially commissioned by PICA.

The term 'kinesphere' refers to the space that can be reached and demarcated by extended limbs and was coined by body movement theorist Rudolf Laban. In an attempt to stretch and redefine our personal kinespheres, Coates has developed expansive wall drawings, created a mountainous structure housing a micro-cinema, and transformed a gallery into an interactive climbing room.

Erin Coates' projects always begin with drawing – whether it is a sketch, a graphite rendering of a plan or a storyboard for a film. Recently, the role of drawing and the function of the line in her work has shifted from a process-based activity to a diagrammatic one that also records climbing sequences. Lines and routes, punctuated by symbols and directions weave up and around public art works and suburban facades. In this way Coates creates a graphic notation of a series of movements of the body in three-dimensional space.

This major new project by Erin Coates unites physical encounters, drawn and sculptural forms, and complex digital and 3D video works. Coates had to learn new languages from different communities and disciplines as she worked with teams of climbers, artists, engineers and architects. She collaborated with Gresley Abas Architects to translate the idea of her massive *Thigmataxis* structure into a 3D design in ArchiCAD software. This in turn was handed to Wintech Engineers for them to carve up every plane of the structure into 163 polystyrene

parts in order for it to be transported and then constructed into a 7.2 metre sculpture inside PICA's main gallery.

Embedded in the cladding of this structure are sequences of proposed climbs of the PICA clock tower. Inside it houses an immersive micro cinema in which a vertiginous, fast paced film- a manifesto of city and suburban transgression through bouldering and parkour- plays out to heart-racing effect with a polyrhythmic percussive soundscape by Stuart James. This local experimental musician accompanied the artist on her climbs to build up a library of field recordings of the sound of the body's contact with artworks and architecture.

Coates' trilogy of films in *KINESPHERE*, including *The Last Climber Alive Must Keep Herself Fit and Ready*, *CLIMB ART: institutions* and *Thigmataxis*, montages fragments of climbs on public art works with parkour races across empty car parks and shopping centre rooftops. These climbs are examples of collective authorship, of mutual, shared responsibility as bodies are tested, and risked, and lessons learned through motion.

What sets the *KINESPHERE* project apart from the artist's previous work is the shift from a passive to an active practice – in this space, no one can possibly remain inert or follow the standard routes set by the city and its gridded structures. *KINESPHERE* perhaps constitutes a training manual for how to corrupt one's everyday boundaries, how to move a little differently, a little laterally.

Leigh Robb, Curator, PICA

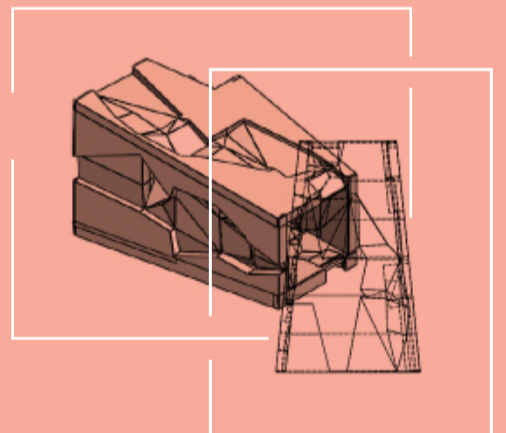
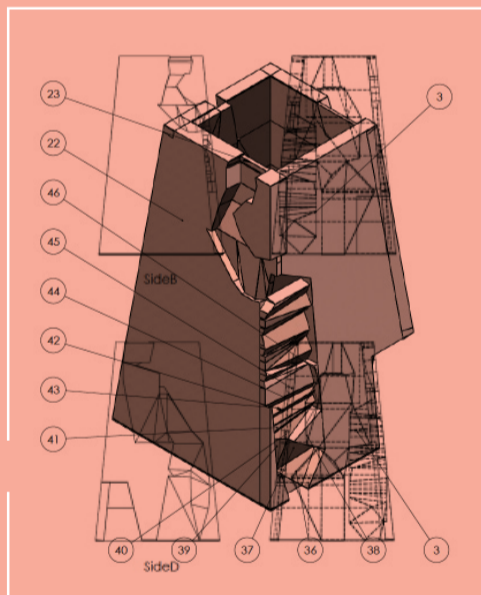

PICA has been able to commission Erin Coates to make this significant new work at a pivotal moment in her career with the support of a Catalyst: Katherine Hannay Visual Arts Commission grant, the City of Perth and the generosity of PICA's ART5000 Donors.

PUBLIC PROGRAMS

LAST WOMAN ALIVE

Saturday 13 September, 3pm
FREE EVENT

Join WA artist Erin Coates and her team of climbers, engineers and sound artists in a journey that traverses art, architecture, sport and urban adventure. In a discussion led by PICA Curator Leigh Robb, this fearless collective will disclose the behind-the-scenes production processes and artistic concepts involved in the creation of *KINESPHERE*, Erin's major new commission.

ART AND CLIMBING

School Holiday Workshops

Tuesday 7 October – 7 - 10 year olds
Thursday 9 October – 11 - 14 year olds
Saturday 11 October – All ages (family fun session)
All workshops 1.30pm - 3.30pm

Writer, teacher, climber and contributor to *KINESPHERE* Shevaun Cooley will lead students in a workshop on-site in the main gallery spaces at PICA. Join us as we explore the exhibition, climb the gallery walls and talk about mountains, climbing and art!

\$25 per participant
Bookings: pica.org.au or phone 08 9228 6300

Exhibition Partners



Opening Night Sponsors



Exhibition Sponsors



Media Partner



Government Sponsors



Education Sponsor



Automotive Sponsor

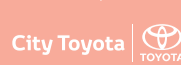

Major Sponsor



PICA's ongoing programs are primarily supported by an investment from the State of Western Australia through the Department of Culture and the Arts in association with Lotterywest, assistance from the Australian Government through the Australia Council, its arts funding and advisory body. PICA is supported by the Visual Arts and Craft Strategy, an initiative of the Australian, State and Territory Governments. PICA has been assisted by the Australian government through its philanthropy and social investment agency for the cultural sector, Creative Partnerships Australia.



PERTH INSTITUTE OF CONTEMPORARY ARTS

Perth Cultural Centre
James Street, Northbridge
Tue-Sun 10am-5pm
tel +61 8 9228 6300
info@pica.org.au | pica.org.au

 - crimp

 - pinch

 - smear

 - one finger pocket

 - two finger pocket

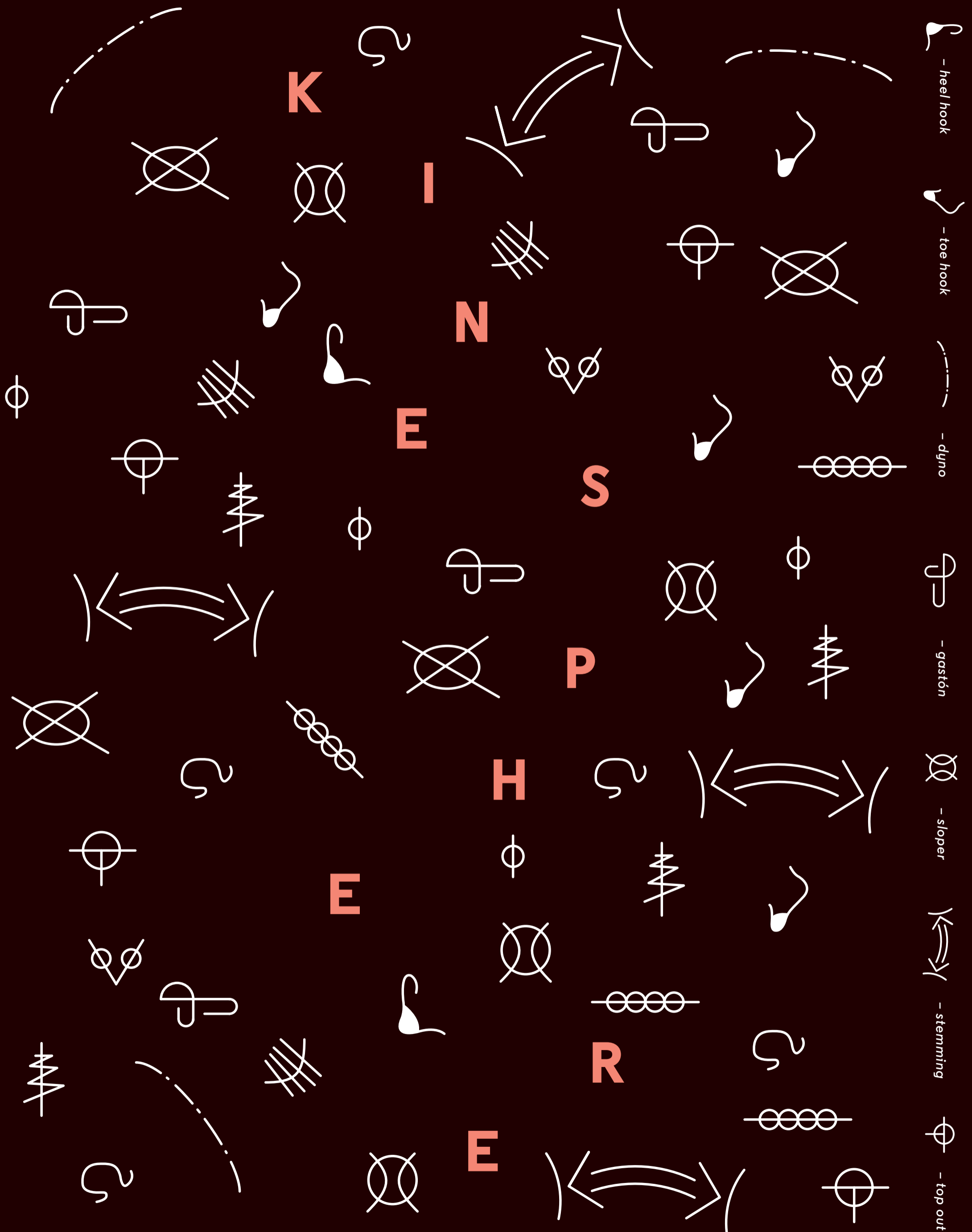

ERIN COATES | KINESPHERE

13 SEPTEMBER – 2 NOVEMBER 2014 | CENTRAL GALLERIES

 - jamming

 - route start